

Data Sheet



Article number: 58SE100S0800G

Description: Cylinder ISO1552 SE 100x800-S-G Ø100-800
port 1/2 - with buffer adjustment

Measures

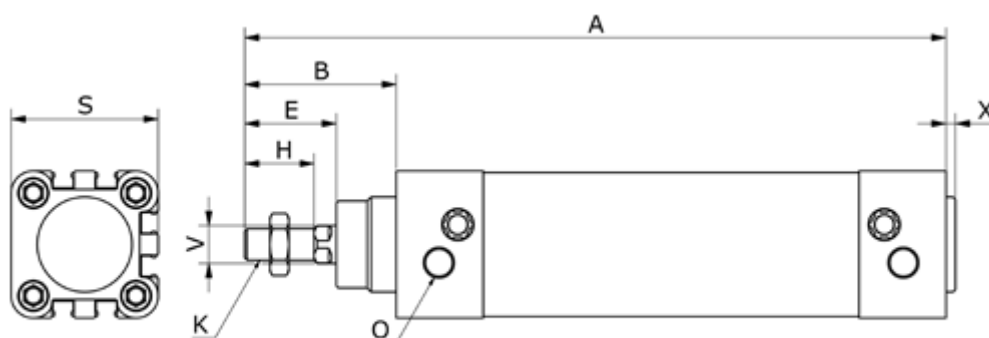

A	= 1029	Stroke = 800
B	= 91	V = 25
Bore diameter	= 100	X = 4
E	= 55	
HS	= 40	
K	= M20x1,50	
O	= 1/2"	
S	= 110.0	